

MOBILITY SCOOTER



Boomerbuggy – Super Transporter

OWNER'S MANUAL

TABLE OF CONTENTS

1.	SAFETY GUIDELINES	2
2.	SAFETY NOTICE.....	3
3.	PARTS INTRODUCTION.....	9
4.	OPERATION.....	10
5.	BATTERY CHARGING AND CARE.....	18
6.	INSPECTION AND MAINTENANCE.....	22
7.	TROUBLE SHOOTING AND SPECIFICATION.....	24

INTENDED USE

Maximum safe slope: 10°

The product is not intended for visually impaired people.

The drivers need to be mentally and physically suitable to drive the scooter.

The fingers need to work functionally.

The device can't be used by children until age of 12 without Parent or Professional approval.

The driving distance will be reduced if the power scooter is used frequently on slopes, rough ground or to climb curbs.

REGARDING DEVICES FOR PRESCRIPTION USE



CAUTION! Federal law restricts this device to sale by or on the order of a physician or other certified personnel licensed by the law of the State (US only) or region in which this personnel practices to use or order the use of this device.

NOTE: This owner's manual is compiled from the latest specifications and product information available at the time of publication. We reserve the right to make changes as they become necessary. Any changes to our products may cause slight variations between the illustrations and explanations in this manual and the product you have purchased. The latest/current version of this manual is available on our website.

NOTE: This product meets IPX4 classification (IEC 60529).



I. SAFETY GUIDELINES

Please carefully read this owner's manual before using the scooter. Improper use of the scooter could result in harm, injury or traffic accidents. Therefore for maximum pleasure while using the scooter please read this owner's manual.

- ◆ This owner's manual includes operation instructions for every aspect of the scooter, assembly instructions, as well as instructions for how to deal with possible accidents.
- ◆ The symbols used in this manual are explained below:
Read especially the notes marked with these symbols:



WARNING! Indicates a potentially hazardous condition/situation. Failure to follow designated procedures can cause either personal injury, component damage, or malfunction. On the product, this icon is represented as a black symbol on a yellow triangle with a black border.



MANDATORY! These actions should be performed as specified. Failure to perform mandatory actions can cause personal injury and/or equipment damage. On the product, this icon is represented as a white symbol on a blue dot with a white border.



PROHIBITED! These actions are prohibited. These actions should not be performed at any time or in any circumstances. Performing a prohibited action can cause personal injury and/or equipment damage. On the product, this icon is represented as a black symbol with a red circle and red slash.

- ◆ This manual includes a copy of repair and maintenance record chart and warranty information. Please keep it in a safe place or in the scooter.
- ◆ If someone else uses the scooter, please make sure that you provide them with the instruction manual for his or her consideration.
- ◆ As designs change some illustrations and pictures in the manual may not correspond to the scooter that you purchased. We reserve the right to make design modifications.

Our scooters have been designed and manufactured to provide a comfortable and secure yet affordable solution for some mobility requirements.



Suggestion

To maximize your batteries efficiency and service life, please fully recharge your new battery before its first time use.



2. SAFETY NOTICE

GENERAL



MANDATORY! Do not operate your new Scooter for the first time without completely reading and understanding this owner's manual and the Consumer Safety Guide.

Your Scooter is a state-of-the-art life-enhancement device designed to increase mobility. We provide an extensive variety of products to best fit the individual needs of the Scooter user. Please be aware that the final selection and purchasing decision regarding the type of Scooter to be used is the responsibility of the Scooter user who is capable of making such a decision and his/her healthcare professional (i.e., medical doctor, physical therapist, etc.).

The contents of this manual are based on the expectation that a mobility device expert has properly fitted the Scooter to the user and has assisted the prescribing healthcare professional and/or the authorized Provider in the instruction process for the use of the product.

There are certain situations, including some medical conditions, where the Scooter user will need to practice operating the Scooter in the presence of a trained attendant. A trained attendant can be defined as a family member or care professional specially trained in assisting a Scooter user in various daily living activities.

As you begin using your Scooter during daily activities, you will probably encounter situations in which you will need some practice. Simply take your time and you will soon be in full and confident control as you maneuver through doorways, on and off elevators, up and down ramps, and over moderate terrain.

Additional general information can be found on the supplemental information sheets and booklets included in your Owner's Package. Please fully read and review the information, and keep it readily available for future reference.

Below are some precautions, tips, and other safety considerations that will help you become accustomed to operating the Scooter safely.

■ **PRE-RIDE SAFETY CHECK**

Get to know the feel of your Scooter and its capabilities. We recommend that you perform a safety check before each use to make sure your Scooter operates smoothly and safely.

■ **Perform the following inspections prior to using your Scooter:**

- ◆ Check the condition of the tires. Make sure they are not damaged or excessively worn.
- ◆ Check all electrical connections. Make sure they are tight and not corroded.
- ◆ Check all harness connections. Make sure they are secured properly.
- ◆ Check the brakes to ensure they operate properly.
- ◆ Check the battery condition meter to ensure the batteries are fully charged.
- ◆ Ensure the manual freewheel lever is in drive mode before sitting on the Scooter.

If you discover a problem, contact your authorized Provider for assistance. Please refer to the Contact Information insert in your Owner's Package.



2. SAFETY NOTICE

WHILE DRIVING

- **Please carry out daily inspections.** Refer to the section entitled “DAILY CHECKING”

- **Do not move your body out of the scooter while moving**
 - ◆ Such action may cause you to lose balance and risk injury from falling.
 - ◆ Pay attention that your clothes do not tangle in the wheels.

- **Do not use your scooter under the circumstances below.**
 - ◆ On roads with heavy traffic or roads that are muddy, gravelly, bumpy, narrow, snowed over, icy, or canal towpaths not guarded by any fence or hedge. Keep away from places where you might get the wheels stuck.
 - ◆ Do not drive at night or when it is raining, snowing, misty, or windy.
 - ◆ Do not drive your scooter in an “S” pattern or make a sharp turn.
 - ◆ Do not take the scooter onto escalators.
 - ◆ UNDER NO CIRCUMSTANCES SHOULD THE SCOOTER BE USED AS A SEAT IN A MOTOR SCOOTER (E.G. CARS, BUSES, TRAINS, ETC).

- **About Mobile Phones and other electrical equipment**
 - ◆ Do not use a mobile phone or other wireless communication devices while driving.
 - ◆ Always switch off the scooter and remove the ignition key before using a mobile phone.
 - ◆ Do not charge the mobile phone or any other electrical devices from your scooter’s battery.

- **Automatic Power Shut Down**

In order to avoid accidental battery run down, your scooter is equipped with an automatic power shut down facility. If the scooter is switched on, after remaining undisturbed for a period of thirty minutes it will automatically turn off. Should this occur, simply switch your scooter off and back on and it will be ready to use once again.

- **Ramps, inclines and drops**
 - ◆ Do not drive onto steep ramps greater than the specified gradient. Refer to the section entitled “CLIMBING ANGLE” in “7. SPECIFICATION“
 - ◆ Always use a low speed setting when ascending or descending a gradient.
 - ◆ Do not drive on roads with large drops or potholes.
 - ◆ Please slow down when driving on roads with inclines.
 - ◆ Do not make sudden turns when driving on gravel roads or ramps.
 - ◆ Always lean forward when climbing a steep gradient.



2. SAFETY NOTICE

■ Starting and Driving

1. Make sure the seat is installed properly.
2. Make sure the tiller has been secured properly.
3. Fold down the armrests so you can rest your arms on them.
4. Turn the power switch to “ON”. If necessary, turn on the headlights.
5. Check battery indicator to see whether there is enough power for your journey. If you have any doubt about the remaining power, please recharge the batteries before departure.
6. Set the speed dial to a position you feel safe and comfortable with.
7. Check the forward/reverse speed lever works correctly.
8. Make sure the electromagnetic brake works correctly.

Make sure it is safe around you before you drive on the street.

WARNING !



- Do not set in the freewheel mode when driving on a gradient.
- Always re-engage the anti-freewheel device before use. Fail to do so may result in injury.
- To protect your safety, the power will automatically cut off and electromagnetic brake system will activate while you are driving down a steep gradient. This will limit the speed to a safe level. Turn the power on again to re-start your scooter.

Maximum User Weight Limit

- Refer to section entitled “MAX. USER WEIGHT” in “ 8. SPECIFICATION “. Overloading past the weight limit may lead to damage of your scooter or cause it to malfunction and will endanger your safety. The warranty does not cover this type of damage.

Attention



1. Do not turn the power switch to OFF while driving as this will lead to an emergency stop and possible risk of accident and injury.
2. Do not set to the highest speeds while driving indoors.
3. Do not adjust the speed dial while driving, a sudden change in speed may cause danger to you and others, and may cause damage to your scooter.
4. Do not place magnetic devices near the area of the operation handle as this could affect the safe operation of your scooter.
5. Do be careful while driving in heavy traffic or crowded areas.
6. While reversing the scooter, beware of people or objects behind you.

2. SAFETY NOTICE

Stopping

1. Release the speed control lever completely. The scooter will naturally brake and stop.
2. Turn the power switch to (OFF). Then pull out the key.

Motor Vehicle Transport

Daymak recommends that you do not remain seated in your scooter while traveling in a motor vehicle. The scooter should be stowed in the trunk of a car or in the back of a truck or van with the batteries removed and properly secured. In addition, all removable scooter parts, including the armrests, seat, and shroud should be removed and/or properly secured during motor vehicle transport.

WARNING! Do not sit on your scooter while it is in a moving vehicle.



WARNING! Always be sure your scooter and its batteries are properly secured when it is being transported. Batteries should be secured in an upright position and protective caps should be installed on the battery terminals. Batteries should not be transported with any flammable or combustible items.

Lift/Elevation Products

If you will be transporting your scooter during travel, you may find it necessary to use a vehicle-mounted lift system or elevation product to aid in transportation. Daymak recommends that you closely review the warnings, instructions, specifications, and safety information set forth by the manufacturer of the lift/elevation product before using that product.



WARNING! Always turn off the power to the unit when you are being transferred via an elevation product. Failure to do so may result in accidental throttle control lever contact, resulting in unintended movement and personal injury or product damage.

Stairs and Escalators

Scooters are not designed to travel up or down stairs or escalators. Always use an elevator.



WARNING! DO not use your scooter to negotiate steps or escalators.

2. SAFETY NOTICE

LABELING

Please carefully read all labels on the scooter before driving it. For your future reference, do not remove them.



1. WARNING EMI LABEL.....

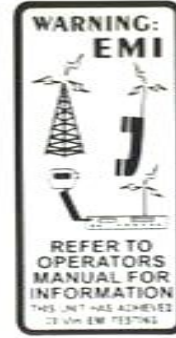

2. FREEWHEEL LABEL.....



3. SEAT PINCH WARNING LABEL.....



2. SAFETY NOTICE

EMI

This portion of the content will provide the user with basic information that describes the problems with EMI, known sources of EMI, protective measures either to lessen the possibility or exposure or to minimize the degree of exposure, and suggested action should unexpected or erratic movement occur.





Caution:

It is very important that you read this information regarding the possible effects of electromagnetic interference on your electric scooter.

■ **ELECTROMAGNETIC INTERFERENCE (EMI) FROM RADIO WAVE SOURCES**

Powered scooter may be susceptible to electromagnetic interference (EMI), which is interfering electromagnetic energy (EM) emitted from sources such as radio stations, TV stations, amateur radio (HAM) transmitters, two-way radios, and cellular phones. The interference (from radio wave sources) can cause the powered scooter to release its brakes, move by itself, or move in unintended directions. It can also permanently damage the powered scooter's control system. The intensity of the interfering EM energy can be measured in volts per meter (V/m). Each powered scooter can resist EMI up to a certain intensity. This is called its "immunity level". The higher the immunity level, the greater the protection. At this time, current technology is capable of achieving at least a 20 V/m immunity level, which would provide useful protection from the more common sources of radiated EMI. This powered scooter model as shipped, with no further modification, has an immunity level of 20 V/m without any accessories.

There are a number of sources of relatively intense electromagnetic fields in the everyday environment. Some of these sources are obvious and easy to avoid. Others are not apparent and exposure is unavoidable. However, we believe that by following the warning listed below, your risk to EMI will be minimized.

The sources of radiated EMI can be broadly classified into three types:

1. Hand-held portable transceivers (transmitter-receivers with the antenna mounted directly on the transmitting unit. Examples include: citizens band (CB) radios, " walkie talkie", security, fire, and police transceivers, cellular telephones and other personal communication devices.
2. Medium-range mobile transceivers, such as those used in police cars, fire trucks, ambulances and taxis. These usually have the antenna mounted on the outside of the Scooter,
3. Long-range transmitters and transceivers, such as commercial broadcast transmitter (radio and TV broadcast antenna towers) and amateur (HAM) radios;



3. PARTS INTRODUCTION

PARTS DESCRIPTION

- | | | |
|------------------------------|--------------------------------|------------------------|
| 1. Power switch | 2. Charger Socket Cover | 3. Tiller Extend Lever |
| 4. Tiller Angle Adjust Lever | 5. Separate Frame safety Lever | 6. Seat Rotate Lever |
| 7. Battery Case handle | 8. Frame Separate Handle | 9. Circuit Breaker |
| 10. Freewheel Lever | 11. Anti-tip Wheel | |

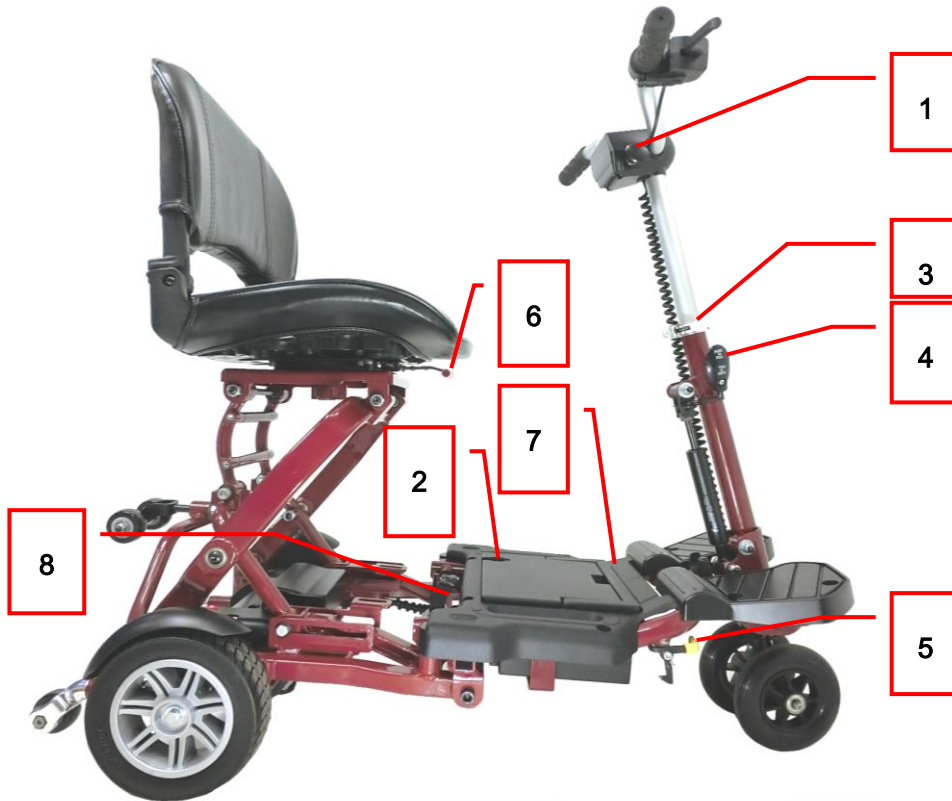

4. OPERATION

4.1 CONTROL PANEL

1. Battery Level Indicator
2. Forward / Reverse Selector



PROHIBITED! Do not expose the tiller console to moisture. In the event that the tiller console does become exposed to moisture, do not attempt to operate your Scooter until the tiller console has dried thoroughly.

4.2 HOW TO OPERATE YOUR SCOOTER

■ Power switch

INSERT or PULL OUT the key to power ON or OFF

(ON) : Power is turned on

(OFF) : Power is turned off



WARNING!

If the key is moved to the “off” position while your Scooter is in motion, the electronic brakes will engage and your Scooter will come to an abrupt stop!

■ Operating Lever

- ◆ To start driving, squeeze the operating lever, gently until you reach the desired speed.
- ◆ The speed is directly proportional to the deflection of this lever.
- ◆ To stop – release the operating lever. The scooter will stop gradually.



4. OPERATION

■ Braking

- ◆ Release the speed control lever freely while either going forward or reverse, and the electromagnetic brake in the motor will be activated, and the scooter will stop.

■ Battery Indicator

The battery indicator on the tiller console uses a color code to indicate the approximate power remaining in your batteries. Green indicates (40 ~ 100%) capacity, yellow a draining charge (10 ~ 30%), and red indicates that an immediate recharge is necessary.

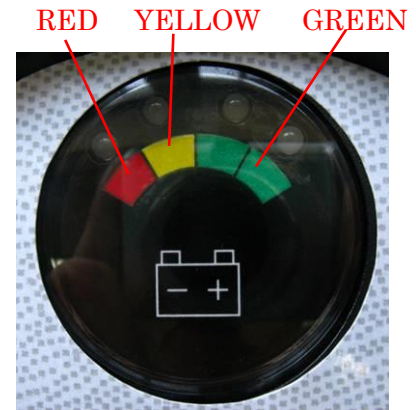

The remaining power suggested by the battery indicator will vary by the actual driving time incurred and how you drive. Repeated starting, stopping, climbing will consume the power more quickly.

■ Power Down Timer Feature

Your Scooter is equipped with an energy saving automatic power down timer feature designed to preserve your Scooter's battery life. If you mistakenly leave the key in the key switch and in the "on" position but do not use your Scooter for approximately 20 minutes, the Scooter's controller shuts down automatically.

If the power down timer feature takes effect, perform the following steps to resume normal operation.

1. Remove the key from the key switch.
2. Reinsert the key and power up your Scooter.

4. OPERATION

How To Set Freewheel Mode

Whenever you need or want to push your Scooter for short distances, you can put it in freewheel mode.

1. Locate the manual freewheel lever at the top right of the rear section.
2. Push forward on the manual freewheel lever to disable the drive system and the brake system. You may now push your Scooter.
3. Push the manual freewheel lever rearward to reengage the drive and the brake systems; this takes your Scooter out of freewheel mode.

WARNING! When your Scooter is in freewheel mode, the braking system is disengaged.



- Disengage the drive motors only on a level surface.
- Ensure the key is removed from the key switch.
- Stand to the side of the scooter to engage or disengage freewheel mode. Never sit on a scooter to do this.
- After you have finished pushing your Scooter, always return it to the drive mode to lock the brakes.



WARNING! Before placing your Scooter into or taking it out of freewheel mode, remove the key from the key switch. Never sit on a Scooter when it is in freewheel mode. Never put a Scooter in freewheel mode on any incline.

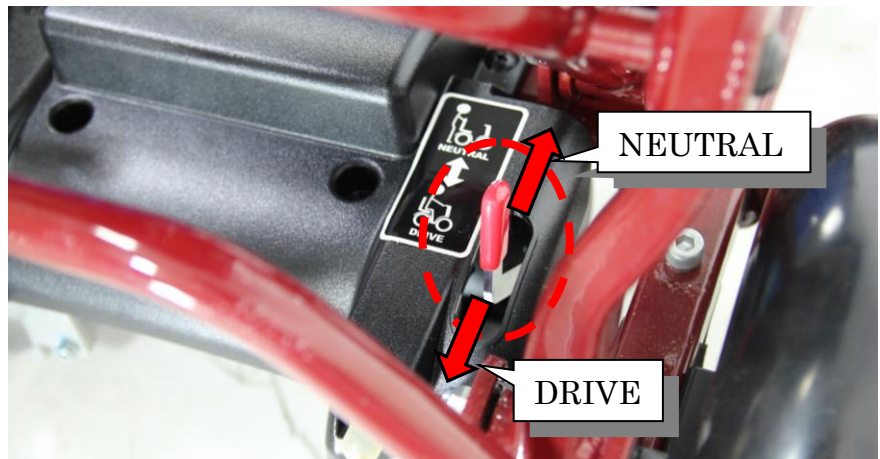

Anti-Tip Wheels

The anti-tip wheels are an integral and important safety feature of your Scooter. They are bolted to the frame at the rear of the Scooter.



PROHIBITED! Do not remove the anti-tip wheels or modify your Scooter in any way that is not authorized by your Provider.



WARNING! The anti-tip wheels may cause interference with the smooth transition of your Scooter when ascending or descending a curb. Contact your authorized Provider for more information.

4. OPERATION

■ Tiller Adjustment

The tiller can be adjusted in to many different positions to suit each driver.

1. Loosen the lever to adjust the tiller to positions you want.
2. Once decide the position, tighten the lever to secure the tiller.



WARNING! Remove the key from the key switch before adjusting the tiller or the seat. Never attempt to adjust the tiller or the seat while the Scooter is in motion.



WARNING! Prior to operating the scooter, push and pull on the tiller to ensure that the angle adjustment mechanism is secure. Inspect the tiller adjustment knob and the angle adjustment mechanism to ensure that they are fully engaged. If there is movement in the tiller, check to make sure that the tiller adjustment knob is fully tightened.



■ Seat

- ◆ The seat can be turned to 45 degrees or 90 degrees.
- ◆ Pull the seat adjustment lever swivel seat.
- ◆ Release the lever, then continue swiveling the seat until it locks in position.



Attention

- Return the seat to the forward position before driving.

4. OPERATION

■ Main Circuit Breaker (Reset Button)

When the voltage in your Scooter's batteries becomes low or the Scooter is heavily strained because of excessive loads or steep inclines, the main circuit breaker may trip to protect the motor and electronics from damage.

- The main circuit breaker reset button pops out when the breaker trips.
- When the breaker trips, the entire electrical system of your Scooter shuts down.
- Allow a minute or two for your Scooter's electronics to "rest."
- Push in the reset button to reset the main circuit breaker.
- If the main circuit breaker trips frequently, you may need to charge your batteries more often. You may also need to have your authorized Provider perform a load test on your Scooter's batteries.
- If the main circuit breaker trips repeatedly, see your authorized Provider for service.



■ BATTERY PACK

Your Scooter is equipped with an innovative, easy-to-remove battery pack. A handle on the top of the battery pack makes it easy to lift the pack off of the Scooter with one hand. The battery pack contains two rechargeable batteries.



WARNING! Ensure Scooters are properly secured to the motor scooter during transport. Scooters that are not properly secured can become a hazard to the user and to other scooter passengers in the event of a crash, sudden stopping, or swerving, as the Scooter could tip or slide out of place.

4. OPERATION

■ Disassembling The Scooter



WARNING! To avoid personal injury, ask for assistance, if necessary, while disassembling or assembling your scooter.



Please follow the steps.

1. Turn key switch to “OFF”.
2. Place the freewheel mode lever in the drive position.



3. Pull the seat adjustment lever swivel seat



4. OPERATION

4. pick up the frame separately with handle bar and fold the rear frame.

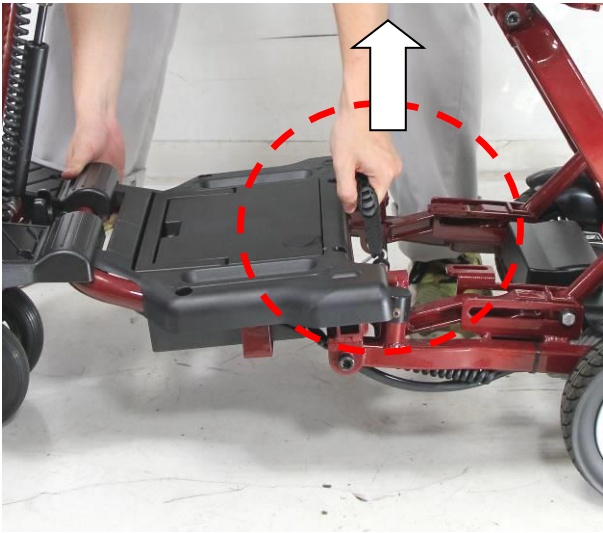

5. push the tiller adjustment knob and fold tiller.

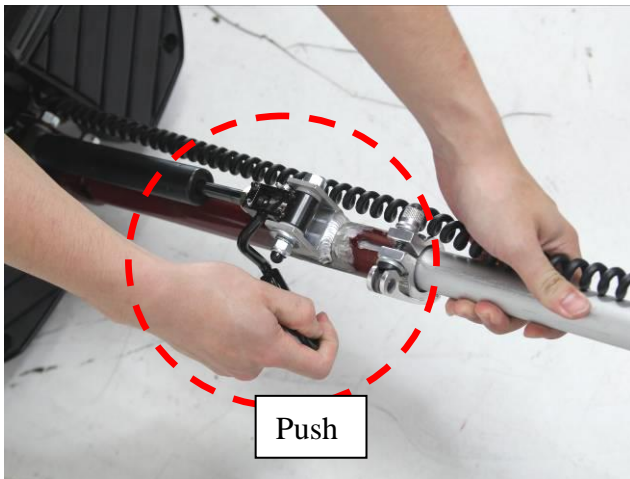

6. Loosen the tiller adjustment lever and fold down the tiller and retighten lever.

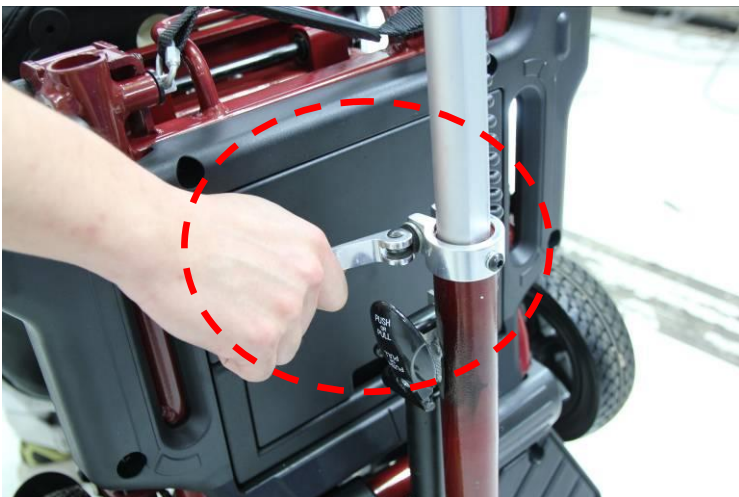

4. OPERATION

■ Assembling The Scooter

No tools are required to disassemble or assemble your scooter.

1. Push the tiller adjustment knob Set the tiller angle.



2. Pull the Separate Frame safety Lever to unfolded.



3. Put down the front and rear sections until the scooter is level.
4. Pull the seat adjustment lever swivel seat



5. Loosen the tiller adjustment lever and extend the tiller and retighten lever.
6. Turn key switch to "ON". Make sure battery gauge indicates sufficient power.

5. BATTERY CHARGING AND CARE

■ CHARGING THE BATTERY

Follow the procedure below step by step:

1. Turn the power switch to (OFF)
2. Connect the charger's power cord into the power outlet.
3. Open the charging socket cap on the battery pack. Then connect the charger's round plug to the charging socket.
4. Turn on the switch on the charger.
5. Both the charger's red and orange LEDs will be lit when beginning charging. The charging duration is about 6 hours. To ensure optimum performance a 10-hour charge is recommended. But we do not recommend a charging more than 24 consecutive hours.
6. Both the charger's LEDs will be lit during the charging process. The orange LED will turn green when charging is complete.
7. Turn off the charger; disconnect the power cord and the round plug from charger socket on the scooter.



This charger meets IP21 (International Protection Marking , IEC 60529)

📖 Suggestions

There is a charger inhibit function on your scooter. The scooter will not run and the battery condition meter will not operate while the batteries are charging.



WARNING!

1. To prolong charger life, do not connect the short output for long time.
2. Though charger charge automatically and can be used for deeply discharged battery, do not use for extremely discharged, short aged and defective battery.
3. Use the charger in a well-ventilated area.
4. Use for LEAD ACID batteries 12V (12-60Amp-Hr.) *2 only.
5. Do not use for voltage input except the specified.

(Make sure your present voltage input 115V or 230V and adjust manually)

5. BATTERY CHARGING AND CARE

■ BATTERY

- ◆ Do not expose the battery to temperatures below 10° C or above 50° C when charging or storing the scooter. Under the above temperature range can cause the battery either to freeze or over heat. This will damage the batteries and shorten their life.
- ◆ These batteries are maintenance free and there is no need to refill with water.
- ◆ You are required to recharge the batteries on a regular basis. Even if the scooter is stood idle, you should charge the batteries at least once a week.
- ◆ The batteries carry a six-month manufacturer's warranty. This warranty only covers issues relating to manufacturing faults, and not faults relating to failure to recharge the batteries as instructed above.

📖 Suggestion – How to maximize your batteries efficiency and service life

1. Fully recharge your new battery before its first time use.
2. Be sure to charge the battery fully every time. The battery life will be seriously shortened or decayed if the battery is repeatedly used without being fully charged.
3. Always complete the charging until the orange LED light turns green. NEVER stop charging before it is complete.
4. Keep your batteries fully charged whenever possible.
5. If you do not use your scooter for a long time, it should be charged at least every week to keep the battery in a fully usable condition.
6. The ambient temperature will affect charging time. Charging time will be longer in the winter.
7. After charging, do not leave the charger socket plugged in to the scooter, as this will cause a power drain on the scooter and temporarily reduce its range.



5. BATTERY CHARGING AND CARE



PROHIBITED! Removal of grounding prong can create electrical hazard. If necessary, properly install an approved 3-pronged adapter to an electrical outlet having 2-pronged plug access.



PROHIBITED! Never use an extension cord to plug in your battery charger. Plug the charger directly into a properly wired standard electrical outlet.



PROHIBITED! Do not allow unsupervised children to play near the Scooter while the batteries are charging. We recommend that you do not charge the batteries while the Scooter is occupied.



MANDATORY! Read the battery charging instructions in this manual and in the manual supplied with the battery charger before charging the batteries.



WARNING! Explosive gases may be generated while charging the batteries. Keep the Scooter and battery charger away from sources of ignition such as flames or sparks and provide adequate ventilation when charging the batteries.

WARNING! You must recharge your Scooter's batteries with the supplied off-board charger. Do not use an automotive-type battery charger.

WARNING! Inspect the battery charger, wiring, and connectors for damage before each use. Contact your authorized Provider if damage is found.



WARNING! Do not attempt to open the battery charger case. If the battery charger does not appear to be working correctly, contact your authorized Provider.

WARNING! If the battery charger is equipped with cooling slots, then do not attempt to insert objects through these slots.

WARNING! Be aware that the battery charger case may become hot during charging. Avoid skin contact and do not place on surfaces that may be affected by heat.



WARNING! If your battery charger has not been tested and approved for outdoor use, then do not expose it to adverse or extreme weather conditions. If the battery charger is exposed to adverse or extreme weather conditions, then it must be allowed to adjust to the difference in environmental conditions before use indoors. Refer to the manual supplied with the battery charger for more information.

5. BATTERY CHARGING AND CARE

■ Cleaning the battery

If the batteries are contaminated by water, battery acid, dust or other substances, they will discharge quickly. The batteries supplied with the Daymak scooter are sealed and as such are maintenance free with no risk of battery leakage.



1. The wiring system is well situated in battery pack while assembled in plant. Do not attempt to re-locate the wiring system by yourself. The improper layout of wiring system may result in the wires pinched by battery box, which might the electronic system failure.
2. Be sure the battery wires are connected to their right battery terminal.
3. If necessary, ask for help from your dealer for advice about maintaining and replacing the battery.

📖 Suggestions

1. Make sure the terminals are installed properly and put the cover back on.
2. Do not use the battery to charge telecom equipment or other items.
3. Battery efficiency will vary with outside conditions; the driving distances will be shorter in the winter. If the scooter is not used for a long time, please charge the battery at least every week.
4. Replace both batteries together.



6. INSPECTION AND MAINTENANCE

■ INSPECTION

- ◆ Clean the scooter with a damp cloth and dust down approximately once a week to preserve the appearance of the scooter.
- ◆ Adjust the tiller height and return to the original position and swivel the seat once a week to ensure the parts adjust and remove smoothly and easily when required.
- ◆ Check for signs of wear and tear on the tires and the upholstery on a regular basis.
- ◆ For optimum performance and to increase the lifespan of your scooter, it is recommended that you have your scooter serviced once a year.

■ REGULAR CHECKING RECORD

To make sure your scooter is correctly serviced, take it to your dealer for regular maintenance checks. This should be at intervals of six months after the first inspection after one month. Your dealer may charge a fee for this service.

YEAR	1	2	3	4	YEAR	1	2	3	4
Service Dates					Service Dates				
Controller					Upholstery				
On/off switch					Seat				
Controller Lever					Back				
Braking					Armrests				
Recharge point					Electrics				
Batteries					Connections condition				
Levels					Lights				
Connections					Test run				
Discharge test					Forwards				
Wheels and Tyres					Reverse				
Wear					Emergency stop				
Pressure					Left turn				
Bearings					Right turn				
Wheel nuts					Slope test				
Motors					Over obstacles				
Wiring					List Items repaired				
Noise									
Connections									
Brake									
Brushes									
Chassis									
Condition									
Steering									



6. INSPECTION AND MAINTENANCE

■ Tires

The condition of the tires depends on how you drive and use your scooter.

- ◆ Inspecting tire tread
- ◆ Please check the tread groove regularly. Replace the tires when the tread groove is less than 0.5 mm.

Attention



1. When tread groove is below 0.5mm it can easily lead to scooter slippage, making braking distances longer. Therefore replace the tires as early as possible when they do not have insufficient tread depth.
2. When conducting maintenance of your scooter, please turn the power switch to OFF and remove the charger cords.

📖 Suggestions

- ◆ Do not splash water directly to wash your scooter as this could lead to malfunction of the system electrics.
- ◆ Do not use petrol, solvents or vaporizing solution as these may deform or damage the shrouds.

■ STORAGE

Make sure the scooter is stored under the following circumstances:

- Make sure the seat is set in the “Forward” position
- Make sure the Power switch is turned to OFF

📖 Suggestion

Please store the scooter in a location where it is away from the direct sunlight, rain, or dew. When storing for a long time, please charge the battery to full power and then disconnect the battery terminal. For details inquire to your scooter dealer.

■ MOVING ABOUT

- ◆ Turn the power switch “OFF” before moving.
- ◆ Lift the scooter by the chassis, and not by the bumpers. Lifting the scooters by the bumper could cause damage or injury.
- ◆ For your safety, always ask for help if required. You will need 2 or 3 persons when moving or lifting the scooter.



7. TROUBLE SHOOTING AND SPECIFICATION

■ TROUBLE SHOOTING

<i>Symptom</i>	<i>Remedy</i>
The scooter will not switch on	<ul style="list-style-type: none"> • Try recharging the battery • Check the fuse and circuit breaker in the scooter
The scooter switches on, but the scooter will not move.	<ul style="list-style-type: none"> • Ensure there is enough power in the batteries. If not, recharge the batteries. • Ensure the freewheel lever is engaged in the 'DRIVE' position.
The scooter appears slow	<ul style="list-style-type: none"> • Check the battery power level and recharge • Check the speed dial is not set to slow.
The seat turns when in operation	<ul style="list-style-type: none"> • Slowly rotate the seat until it drops in to place and is secure
The handlebar appears loose	<ul style="list-style-type: none"> • Tighten the height adjustment handle to secure the handlebar
Involuntarily horn sounds	<ul style="list-style-type: none"> • Ensure that the wigwag paddle is released. • Switch the scooter off and on. • Recharge the batteries. • If problem persists contact your Daymak dealer.



7. TROUBLE SHOOTING AND SPECIFICATION

■ SPECIFICATION

Model Reference	Boomerbuggy – Super Transporter
Expand Dimension (L x W x H mm) (L x W x H inch)	47.2" ×20" ×38.1" 1200mm×510mm×970mm
Fold Dimension (L x W x H mm) (L x W x H inch)	20"×18.1"×25.9" 510mm×460mm×660mm
Weight w/i battery	31 kg / 68.2 lbs
without battery	24.5 kg / 53.9 lbs
Battery	10 AH × 2
Controller	DYNAMIC DR50
Front Wheel Size	150×30 Solid
Rear Wheel Size	200×50 Solid
Brake System	Electromagnetic brakes
Control Method	By speed control lever
Max Speed Forward	6.4km/h / 4mph
Cruising range	9 km /14.4 miles (10AH)
Max Loading	115 kg / 253 lbs
drive system	Direct drive the rear wheels
motor specifications	270w × 24V × 1pcs
frame construction type and materials	Aluminum
battery charger type and input voltage	off-board Input AC 100-240V, Output DC 24V, 1.5 Amp
suspension	No
safety features	Anti-tip wheel

Remark: The manufacturer reserves the right to modify the specification if necessary. The final specification is subject to the individual scooter you purchase from your dealer.

Note:

Maximum driving distance is based on an ambient temperature of 20°C, a 75kg driver and a brand new fully charged battery by a constant driving speed at 6.4 km/h with 70% battery power discharged.



Thank you for choosing Daymak!

